

LAKESIDE OF NAPLES AT CITRUS GARDENS
(PUD)

CITRUS LAKE DRIVE

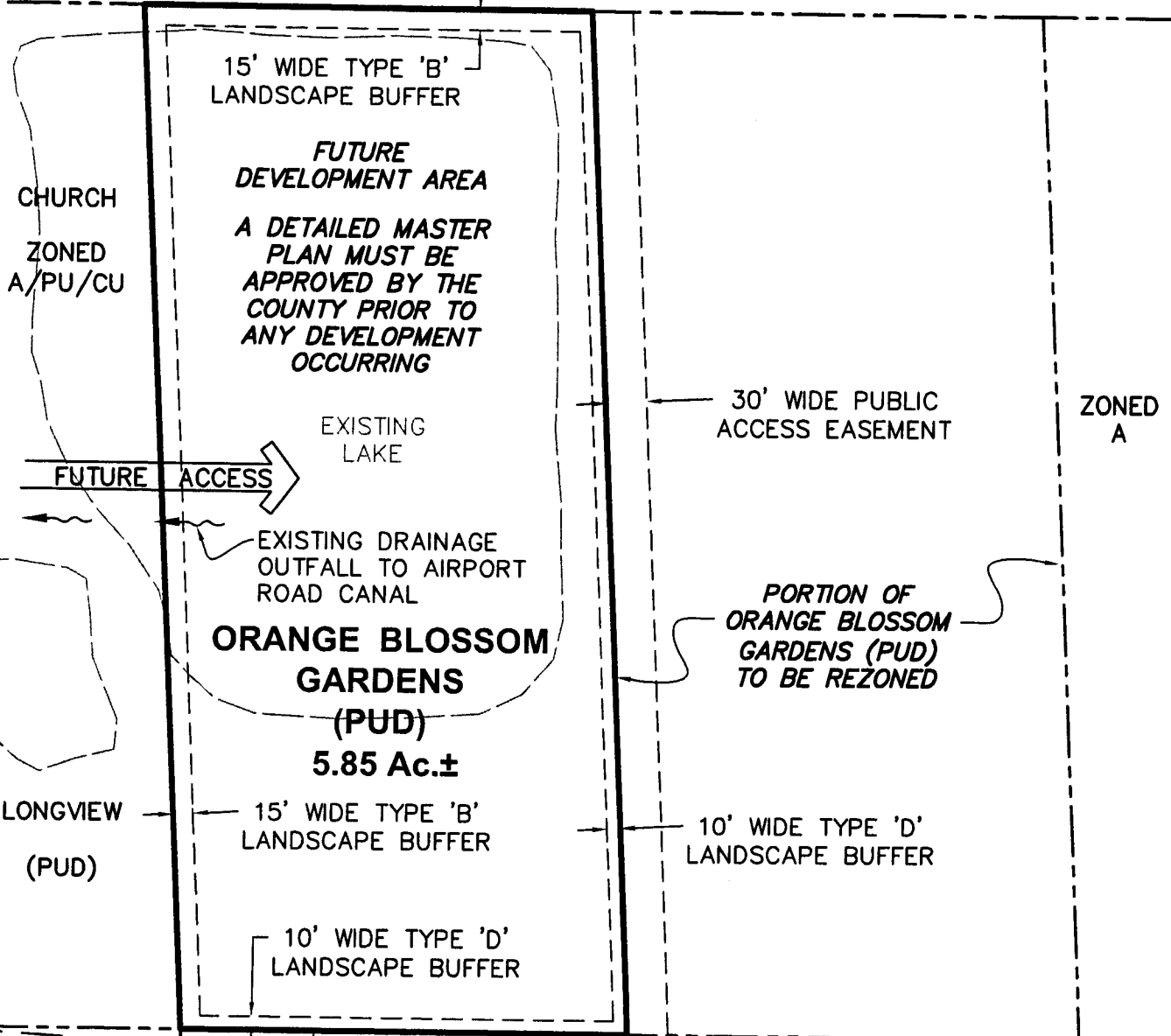

15' WIDE TYPE 'B'
LANDSCAPE BUFFER

**FUTURE
DEVELOPMENT AREA**

**A DETAILED MASTER
PLAN MUST BE
APPROVED BY THE
COUNTY PRIOR TO
ANY DEVELOPMENT
OCCURRING**

EXISTING
LAKE

FUTURE ACCESS

EXISTING DRAINAGE
OUTFALL TO AIRPORT
ROAD CANAL

**ORANGE BLOSSOM
GARDENS
(PUD)**

5.85 Ac.±

30' WIDE PUBLIC
ACCESS EASEMENT

ZONED
A

PORTION OF
ORANGE BLOSSOM
GARDENS (PUD)
TO BE REZONED

LONGVIEW
(PUD)

15' WIDE TYPE 'B'
LANDSCAPE BUFFER

10' WIDE TYPE 'D'
LANDSCAPE BUFFER

10' WIDE TYPE 'D'
LANDSCAPE BUFFER

ORANGE BLOSSOM DRIVE

EXIST. 60' R.O.W.

LONE OAK
(PUD)

LONGVIEW
(PUD)

NOTE :
**NO NATIVE VEGETATION IS REQUIRED
TO BE PRESERVED.**

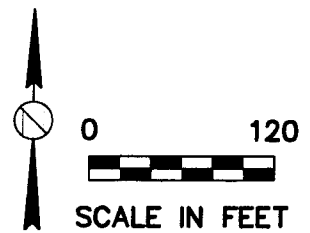

REVISED 12/01/2009

H:\2007\2007115\DW\EXHIBITS\ZONING\ORANGE BLOSSOM GARDENS\Orange Blossom Gardens 15.dwg Tab: PUD MP (8x11) Dec 01, 2009 - 9:29am Plotted by: JonSmith



950 Encore Way
Naples, FL 34110
Phone: (239) 254-2000
Florida Certificate of
Authorization No.1772

Orange Blossom Gardens
PUD Master Plan
Exhibit "A"

CHECKED BY : R.L.D.	PROJECT No. 2007.115
DRAWN BY : JON	CAD FILE NAME: see plotstamp
DATE : 11/08	EXHIBIT - ITEM 1 OF 1